

3B Medical Luna & Luna II Series Power Backup Mode Connection



Required Components

- Freedom V² CPAP Battery
- Freedom V² AC Power Supply
- 150W Sine Wave Power Inverter
- Mobile Power Receptacle (MPR)

*Dual battery connection requires an additional Freedom V² CPAP Battery as well as the Freedom V² Bridge Cable.

Single Battery Connection

- Plug the Freedom V² power supply into the battery DC IN port and then into the wall outlet.
- Plug the Mobile Power Receptacle into the battery DC OUT port.
- Plug the Power Inverter into the Mobile Power Receptacle.
- Plug the 3B Luna series power supply into the Power Inverter.

Dual Battery Connection

To begin the dual battery setup battery A must be charged to at least 15%. Battery B can be at any charge level including 0%.

- Plug the Freedom V² power supply into the DC IN port of battery A and then into the wall outlet. The charge level of this battery must be $\geq 15\%$.
- Plug the Bridge Cable into the DC OUT port of battery A then into the DC IN port of battery B.
- Plug the Mobile Power Receptacle into the DC OUT port of battery B.
- Plug the Power Inverter into the Mobile Power Receptacle.
- Plug the 3B Luna series power supply into the Power Inverter.

Keep your CPAP machine plugged into the Freedom V² CPAP Battery and the battery into the wall outlet. When the power goes out the battery will recognize this and automatically start powering your machine. The built-in cell bypass feature of the Freedom V² means battery power is only used when AC power is lost thus extending the overall life of the battery.

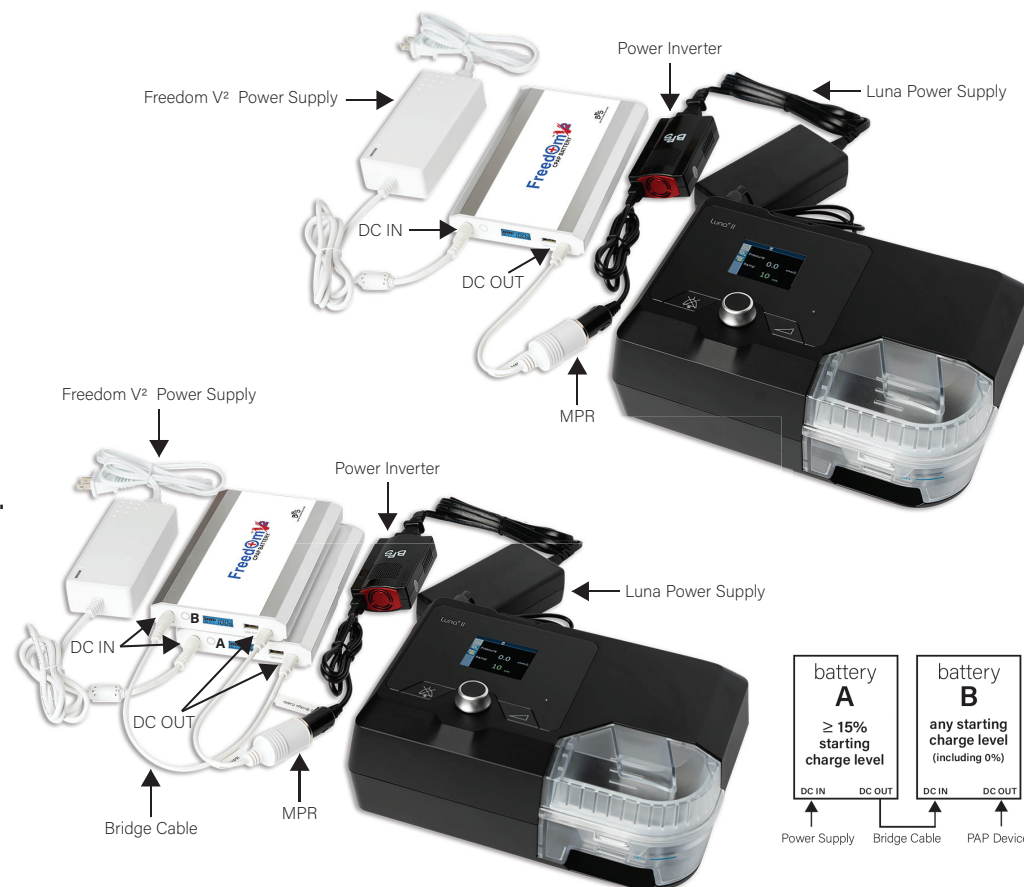

Note: Depending on the device being powered, it is normal for the digital display screen of the batteries to read separate and different voltages. This is due to the voltage output of the Bridge Cable.